

BLAIR REGIONAL YMCA & THE BLAIR COUNTY CONSERVATION DISTRICT BLAIR COUNTY, PENNSYLVANIA

YMCA RAIN GARDEN RECONSTRUCTION PROJECT CONTRACT: 2024-1

AS-BID

JUNE 14, 2024



1731 N. Juniata Street
Hollidaysburg, PA 16648
Phone: 814.696.6280 Fax: 814.696.6240

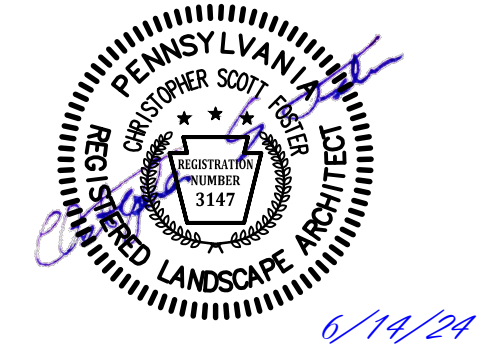

Stiffler, McGraw & Associates, Inc.



PUBLIC UTILITY ACT 38 COMPLIANCE
AREA COVERED BY ONE CALL:
SERIAL NUMBERS:
20241493592

USER	STATEMENT
ALTOONA WATER AUTHORITY WATER DIVISION 852 20TH ST. ALTOONA, PA 16601 ATTN: RICK MCPHEE EMAIL: rmcphoe@altoonawater.gov	CLEAR-NO FACILITIES
BREEZELINE 2200 BEALE AVE. ALTOONA, PA 16601 ATTN: RICK HIMES EMAIL: rhimes@breezeline.com	CLEAR-NO FACILITIES
COMCAST 250 REESE ROAD STATE COLLEGE, PA 16801 ATTN: ROBERT LINGAFELT EMAIL: Robert_Lingafelt@cable.comcast.com	PLANS PROVIDED
FIRSTENERGY CORPORATION 21 S. MAIN ST. AKRON, OH 44308 ATTN: MELLYSSA ADAMS EMAIL: madams@firstenergycorp.com	PLANS PROVIDED
HOLLIDAYSBURG BOROUGH SEWER AUTHORITY 401 BLAIR ST. HOLLIDAYSBURG, PA 16648 ATTN: FRANK HICKS JR. EMAIL: fhicks@hollidaysburpa.org	MARKED
PEOPLES GAS COMPANY LLC 375 N. SHORE DR. PITTSBURGH, PA 15212 ATTN: TODD COEN EMAIL: todd.coen@peoples-gas.com	PLANS PROVIDED

INDEX OF SHEETS

DRAWING	DESCRIPTION
C1	COVER
G1	GENERAL NOTES
E1	EXISTING CONDITIONS PLAN
S1	SITE PLAN
S2	SITE PLAN ENLARGEMENTS
S3	PLANTING PLANS
D1	DETAILS

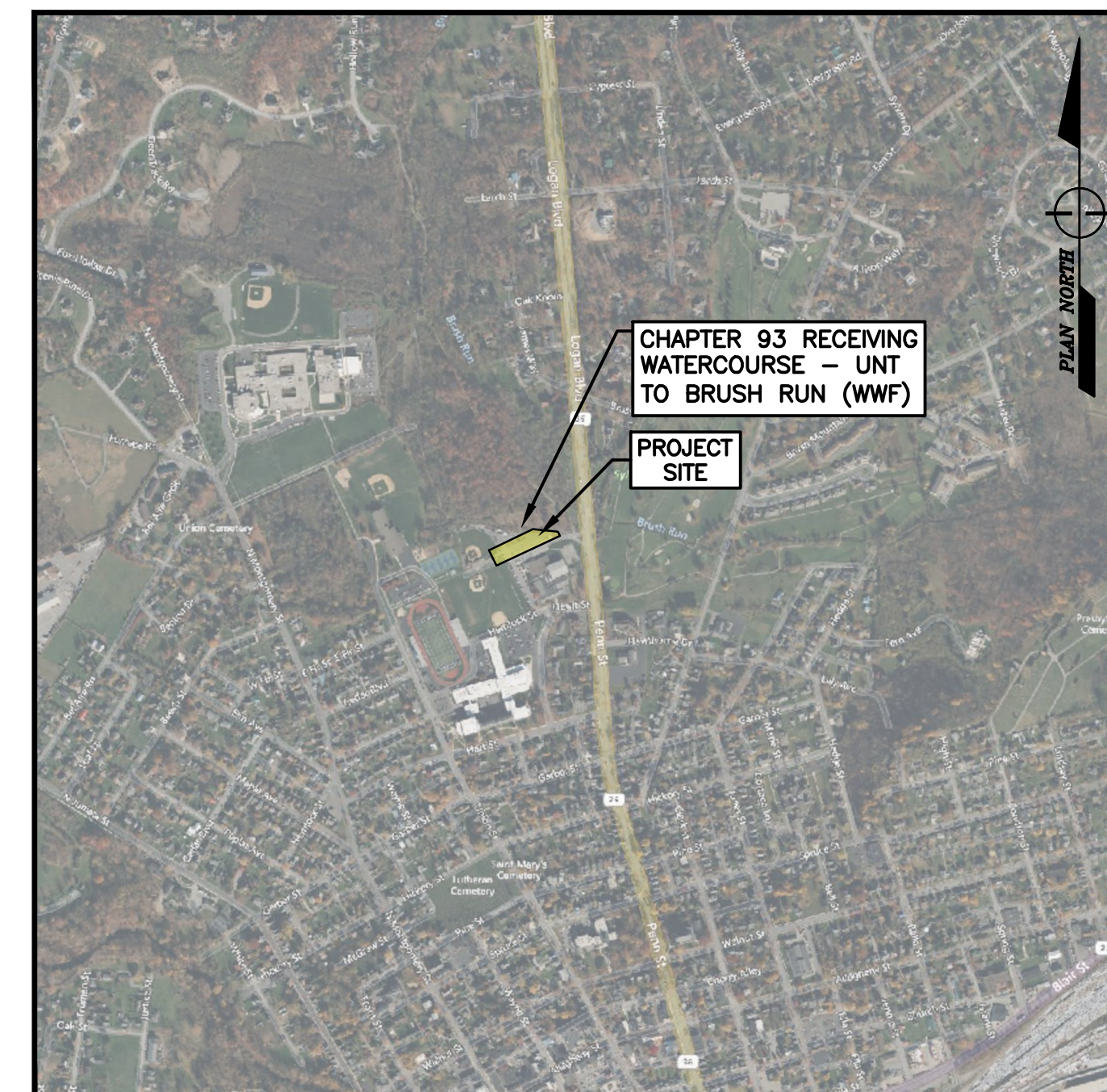

AERIAL IMAGE - 2023 MICROSOFT CORPORATION
LOCATION MAP
SCALE: 1" = 1000'

- PURSUANT TO THE PROVISIONS OF PA ACT 287, AS AMENDED BY ACT 121 OF OCTOBER 9, 2008, PENNSYLVANIA LEGISLATURE, STIFFLER, MCGRAW & ASSOCIATES, INC. HAS INSPECTED OR OBTAINED A LIST OF USERS, AS PRESCRIBED BY SECTION 3 OF SAID ACT WITHIN THE POLITICAL SUBDIVISIONS INVOLVED IN THIS PROJECT. INFORMATION ON THE POSITION AND TYPE OF EACH UNDERGROUND LINE WAS REQUESTED NOT LESS THAN TEN (10), NOR MORE THAN NINETY (90), DAYS PRIOR TO THE COMPLETION OF FINAL DESIGN. EXISTING UNDERGROUND UTILITIES SHOWN ON THESE DRAWINGS ARE BASED ON THE INFORMATION PROVIDED BY THE USERS.
- STIFFLER, MCGRAW & ASSOCIATES, INC., AND THE BLAIR REGIONAL YMCA DO NOT GUARANTEE THE PRESENCE, LOCATION, OR DEPTH OF ANY PUBLIC OR PRIVATE UNDERGROUND UTILITY OR STRUCTURE WHICH MAY OR MAY NOT BE SHOWN ON THESE PLANS.
- PENNSYLVANIA ONE CALL SYSTEM, INC. (1-800-242-1776) SHALL BE NOTIFIED BY THE CONTRACTOR AT LEAST THREE (3) BUSINESS DAYS, BUT NOT MORE THAN TEN (10) BUSINESS DAYS IN ADVANCE OF ACTUAL CONSTRUCTION EXCAVATION FOR VERIFICATION AND MARKOUT OF EXISTING UTILITIES.
- CONTRACTOR SHALL COMPLY WITH ALL REQUIREMENTS OF PUBLIC UTILITY ACT NO. 181 OF DECEMBER 18, 2006.

Revisions:

No.	Date	Description

Sheet Title:

COVER

PROJECT NO.	22-2024
DRAWN BY:	CSF
DESIGNED BY:	CSF
CHECKED BY:	GTG
SCALE:	AS SHOWN

Drawing:

C1

Copyright © 2024 by Stiffler, McGraw & Associates, Inc. Except as permitted under U.S. Copyright laws, no part of this plan may be reproduced, stored in a retrieval system, or transmitted in any form or by any means without the prior written permission of Stiffler, McGraw & Associates, Inc.

GENERAL NOTES

- 1. CURRENT PROPERTY OWNER: BLAIR REGIONAL YMCA
2. SLANT LETTERING INDICATES EXISTING FEATURES OR FACILITIES.
3. VERTICAL LETTERING INDICATES PROPOSED FEATURES OR FACILITIES.
...
13. BEFORE EXCAVATION, ALL UNDERGROUND UTILITIES SHALL BE LOCATED IN THE FIELD BY THE PROPER AUTHORITIES.

ABBREVIATION LIST

Table with 4 columns: Abbreviation, Typical Abbreviations, Some may not apply on this project, and Description. Includes entries for AC, ADT, AGGR, A.V., BLDG, B.C., BL, B.M., B.O., C.B., C/C, C.F., C.F.M., C.F.S., C.M.P., C.I.Q., CL, C.O., CONC., C.P.P., CWF, C.F., C.Y., D.I.P., D.H., DIA., D.I.P., DN, D/S, DWG., EA, EL, ELEC., ELEC., ELEV., E.O.P., E.O.S., EQ., EV., E.W.E.F., EX., F.F., F.F.B., F.D., F.F.E., F.H., H.G.L., F.P., FT., GAL, GND., G.A., G.F., GL., G.M., G.W., H.C., H.O.P., HOR., HORZ., H.P., HQ, H.T., HWY., I.D., INSTR., INV., I.P.F., LAT., LONG., LBS., L.F., L.P., L.P.S., MAX., MB., ME., MF., MFG., M.G.D., MH., MIN., MISC., MON., M.H., N/F, NO., N.T.S., O.C., O.D., OFF., O.B., PCL., PCSWM., PERF., PL., P.O.B., P.O.I., P.S., P.V.C., PVMT., PUB., QTY., R., R.C.P., REF., REQ., REQ'D, REV., R/W, R.O.W., R.R., SAN., SCH., SECT., S.F., S.L.C.P.P., S.R., SS, ST., STA., STD., STM., SQ., S.Y., TAP., T.C., TEMP., TEL., T.G., T.O.C., T.O.G., TRANS., TRAV., TSF., T.V., TWP., TYP., U/G, U.G.E., U.N.O., U.P., U/S, VAC., VER., VERT., V.C.A., W, WITH, W/O, W.L., W.W., W.W.F., W.W.F., W.V., Y.H., YR.

TYPICAL LEGEND

Typical Legend Note: Some typical symbols may not apply on this project.
Categorized into: WATER (Existing/Proposed), SURVEY, STORM SEWER, SANITARY SEWER, GAS, ELECTRIC, COMMUNICATIONS, GENERAL EXISTING, GENERAL PROPOSED.



1731 N. Juniata Street
Holidaysburg, PA 16648
Phone: 814.696.6280 Fax: 814.696.6240

Stiffler, McGraw & Associates, Inc.

Owner:
BLAIR REGIONAL YMCA &
THE BLAIR COUNTY
CONSERVATION DISTRICT
HOLLIDAYSBURG, PENNSYLVANIA 16648

Project Name:
YMCA RAIN GARDEN
RECONSTRUCTION PROJECT

2024-1

HOLLIDAYSBURG BOROUGH
BLAIR COUNTY, PENNSYLVANIA

AS-BID

Revisions:

Table with 3 columns: No., Date, Description

Sheet Title:

GENERAL NOTES

Table with 2 columns: Field, Value
PROJECT NO.: 22-2024
DRAWN BY: CSF
DESIGNED BY: CSF
CHECKED BY: GTG
SCALE: AS SHOWN

Drawing:

G1

Copyright © 2024 by Stiffler, McGraw & Associates, Inc. Except as permitted under U.S. Copyright Act, no part of this plan may be reproduced, stored in a retrieval system, or transmitted in any form or by any means, without the prior written permission of Stiffler, McGraw & Associates, Inc.

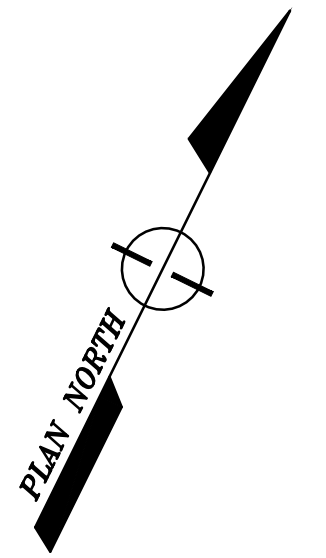

Stiffler, McGraw & Associates, Inc.

Owner:
**BLAIR REGIONAL YMCA &
THE BLAIR COUNTY
CONSERVATION DISTRICT**
HOLLIDAYSBURG, PENNSYLVANIA 16648

Project Name:
**YMCA RAIN GARDEN
RECONSTRUCTION PROJECT**

2024-1

HOLLIDAYSBURG BOROUGH
BLAIR COUNTY, PENNSYLVANIA

AS-BID

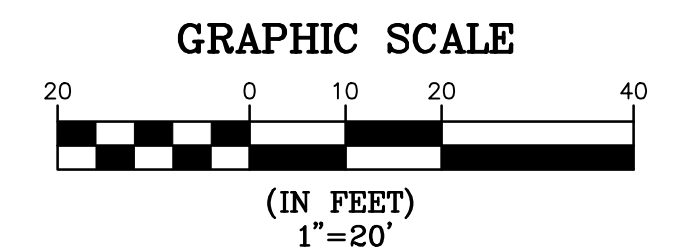

Revisions:

No.	Date	Description

Sheet Title:

**EXISTING
CONDITIONS PLAN**

PROJECT NO.	22-2024
DRAWN BY:	CSF
DESIGNED BY:	CSF
CHECKED BY:	GTG
SCALE:	AS SHOWN

Drawing:

E1

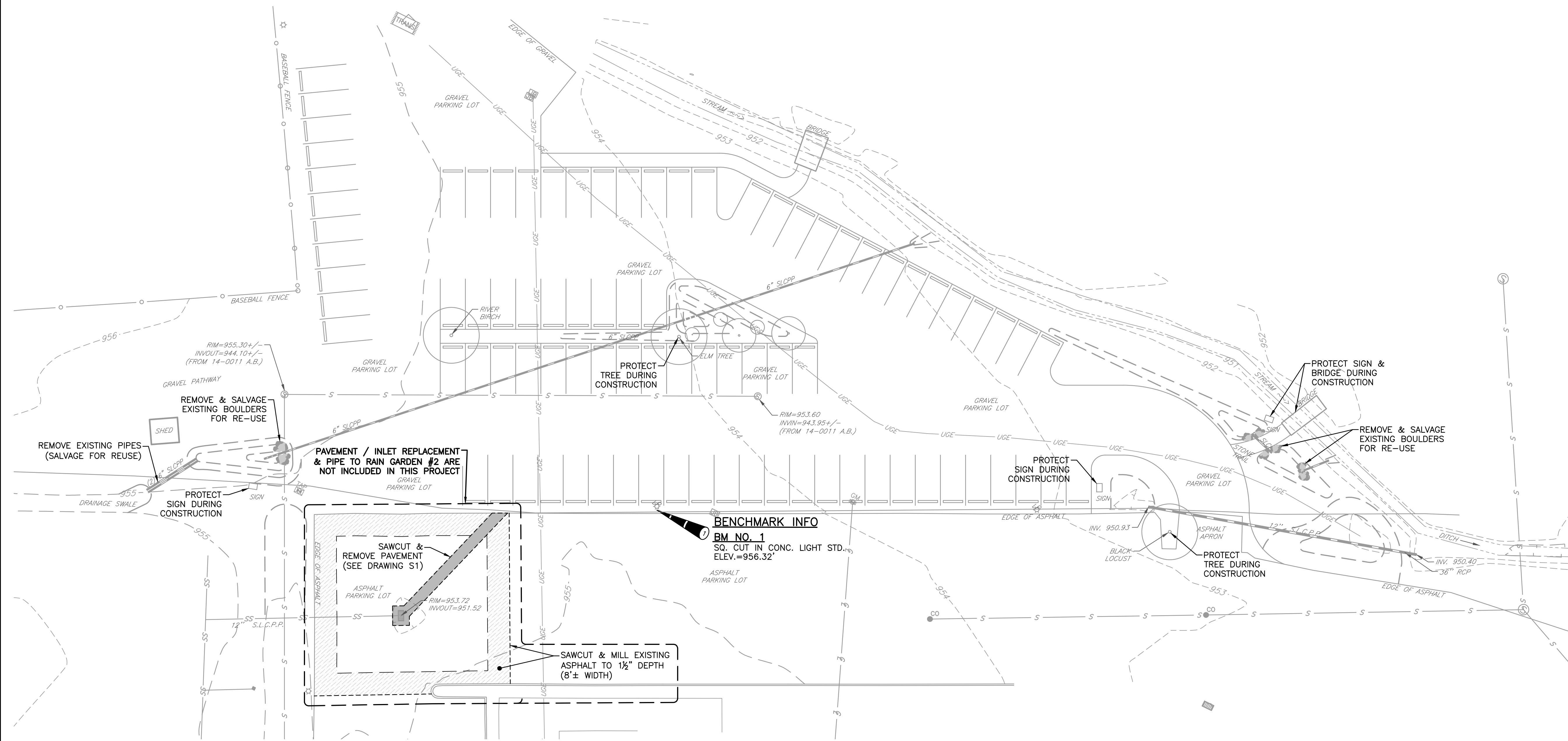

Copyright © 2024 by Stiffler, McGraw & Associates, Inc. Except as permitted under U.S. Copyright laws, no part of this plan may be reproduced, stored in a retrieval system, or transmitted in any form or by any means without the prior written permission of Stiffler, McGraw & Associates, Inc.

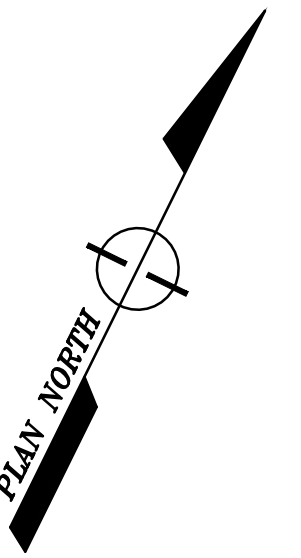

Stiffler, McGraw & Associates, Inc.

Owner:
BLAIR REGIONAL YMCA &
THE BLAIR COUNTY
CONSERVATION DISTRICT
HOLLIDAYSBURG, PENNSYLVANIA 16648

Project Name:
YMCA RAIN GARDEN
RECONSTRUCTION PROJECT

2024-1

HOLLIDAYSBURG BOROUGH
BLAIR COUNTY, PENNSYLVANIA

AS-BID

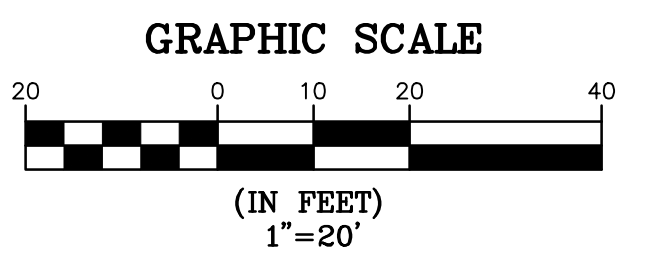

Revisions:

No.	Date	Description

Sheet Title:

SITE PLAN

PROJECT NO.	22-2024
DRAWN BY:	CSF
DESIGNED BY:	CSF
CHECKED BY:	GTG
SCALE:	AS SHOWN

Drawing:

S1

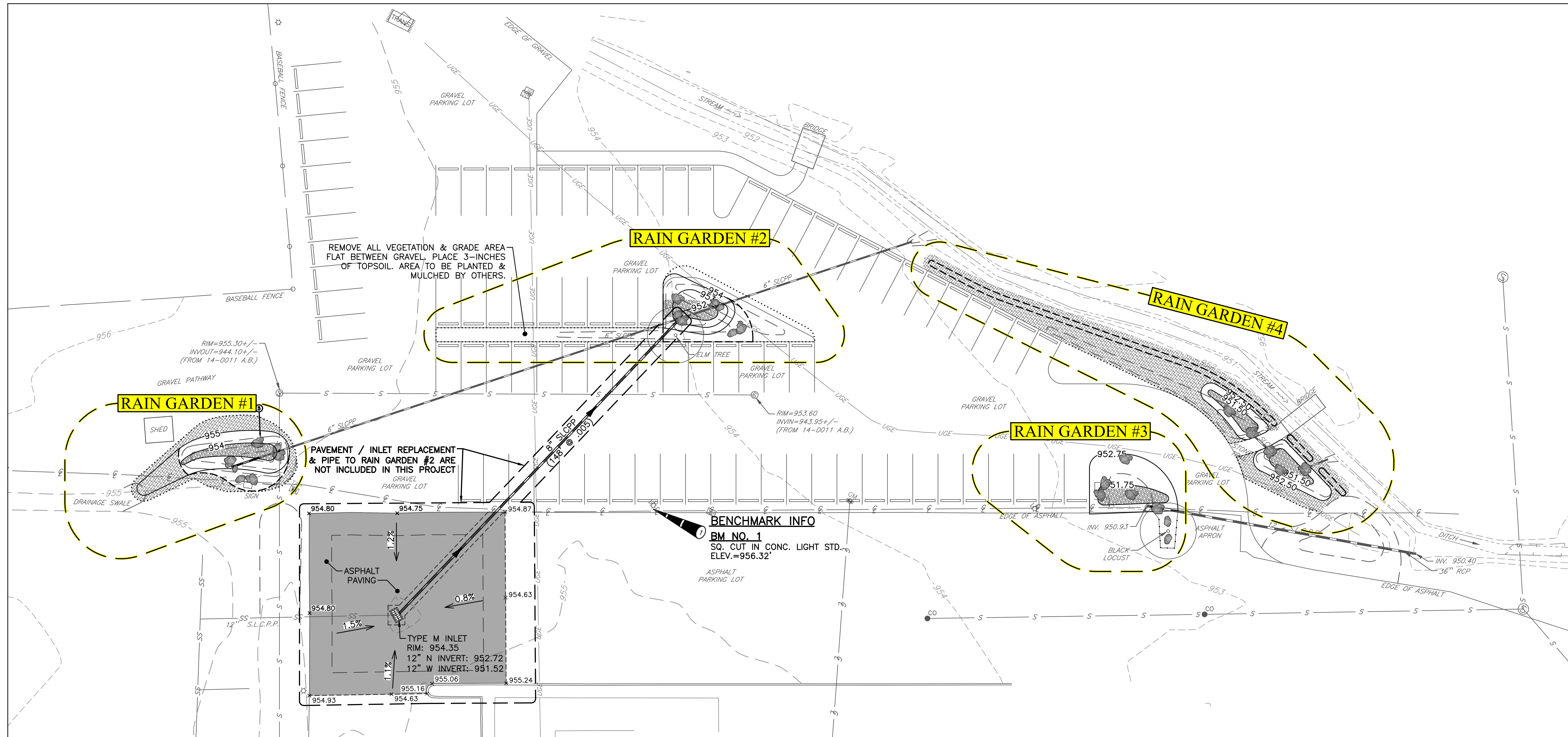

Copyright © 2024 by Stiffler, McGraw & Associates, Inc. Except as permitted under U.S. Copyright laws, no part of this plan may be reproduced, stored in a retrieval system, or transmitted in any form or by any means without the prior written permission of Stiffler, McGraw & Associates, Inc.

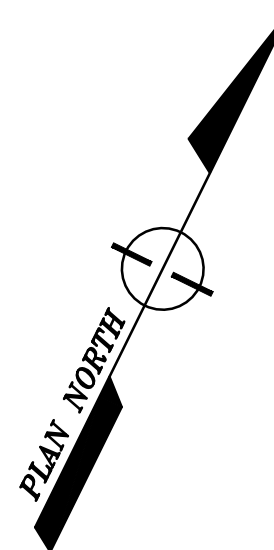

Stiffler, McGraw & Associates, Inc.

Owner:
**BLAIR REGIONAL YMCA &
THE BLAIR COUNTY
CONSERVATION DISTRICT**
HOLLIDAYSBURG, PENNSYLVANIA 16648

Project Name:
**YMCA RAIN GARDEN
RECONSTRUCTION PROJECT**

2024-1

HOLLIDAYSBURG BOROUGH
BLAIR COUNTY, PENNSYLVANIA

AS-BID

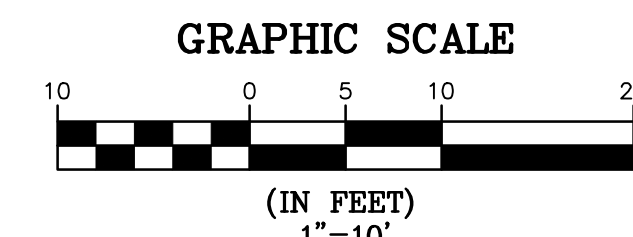

Revisions:

No.	Date	Description

Sheet Title:

**SITE PLAN
ENLARGEMENTS**

PROJECT NO.	22-2024
DRAWN BY:	CSF
DESIGNED BY:	CSF
CHECKED BY:	GTG
SCALE:	AS SHOWN

Drawing:

S2

DETAIL REFERENCES

SEE CONSTRUCTION DETAILS ON DETAIL SHEETS

- ① RAIN GARDEN
- ② PIPE OUTLET
- ③ STANDARD CLEANOUT
- ④ RISER PIPE
- ⑤ BOULDER OUTCROP

PLAN NOTES

- ALL EXISTING PIPES SHALL BE FLUSHED CLEAN OF DEBRIS AND BLOCKAGES, AND REUSED AS INDICATED.
- CONTRACTOR SHALL INSTALL ALL TOPSOIL AND PLANTING SOIL TO PREPARE RAIN GARDENS FOR PLANTINGS. PLANTS ARE TO BE INSTALLED BY OTHERS. SEE LANDSCAPE BED PLANTING DETAIL FOR ADDITIONAL INFORMATION.
- EXISTING BOULDERS ARE TO BE SALVAGED AND REUSED AS INDICATED. CONTRACTOR SHALL SUPPLY ADDITIONAL BOULDERS TO ACHIEVE DESIGNS AS SHOWN.
- RAIN GARDEN #3 RISER PIPE: EXPOSE EXISTING 12" PIPE. CONNECT 6-INCH PERFORATED RISER WITH DOMED CAP TO PIPE (SEE RISER PIPE DETAIL). SET TOP OF RISER AT 952.50. DRILL 1-INCH HOLES VERTICALLY EVERY 2-INCHES BETWEEN GROUND AND CAP. PLACE BOULDERS AROUND RISER PIPE.

SEEDING AND SOIL SUPPLEMENT TABLE

PLACE SEEDING SOIL SUPPLEMENTS ON ALL AREAS IN ACCORDANCE WITH PADOT SPECIFICATIONS, PUB. 408, AND AT THE RATES SPECIFIED BELOW:

FORMULA AND SPECIES	% BY WEIGHT	MINIMUM %		MAX % WEED SEED	SEEDING RATE LBS./1000 S.Y.
		PURITY	GERMINATION		
FORMULA B RESIDENTIAL MIX					42.0 TOTAL
• PERENNIAL RYE GRASS MIXTURE (LOLIUM PERENNE). A COMBINATION OF IMPROVED CERTIFIED VARIETIES WITH NO ONE VARIETY EXCEEDING 50% OF TOTAL RYE GRASS COMPONENT.	20	97	90	0.10	8.5
• CREEPING RED FESCUE OR CHEWINGS FESCUE (FESTUCA RUBRA OR SSP COMMUTATE) (IMPROVED AND CERTIFIED)	30	97	85	0.10	12.5
• KENTUCKY BLUEGRASS MIXTURE (POA PRATENSIS). A COMBINATION OF IMPROVED CERTIFIED VARIETIES WITH NO ONE VARIETY EXCEEDING 50% OF THE TOTAL BLUEGRASS COMPONENT.	50	97	80	0.15	21.0

APPLY SOIL SUPPLEMENTS ON FORMULAS B IN ACCORDANCE WITH PUB. 408 SECTION 804.2b AND AS FOLLOWS:

- PULVERIZED AGRICULTURAL LIMESTONE - 800 LBS. PER 1000 S.Y.
- 10-20-20 ANALYSIS COMMERCIAL FERTILIZER - 140 LBS. PER 1000 S.Y.
- 38-0-0 UREAFORM FERTILIZER - 50 LBS. PER 1000 S.Y.
- OR
- 32-0-0 TO 38-0-0 SULFUR COATED WITH UREA FERTILIZER - 59 TO 50 LBS. PER 1000 S.Y.
- OR
- 31-0-0 IBDU FERTILIZER - 61 LBS. PER 1000 S.Y.

SUPPLEMENTS SHALL NOT BE ADDED WHEN SEEDING FORMULAS C, N, W, R, P, SLOPE AND WILDFLOWER ENHANCEMENT SEEDED AREAS UNLESS INDICATED BY SOIL TEST.

LIME AND FERTILIZER APPLICATION RATES MAY BE ADJUSTED BASED UPON SOIL TESTING.

APPLY MULCHING-STRAW OR MULCHING-HAY AS INDICATED AND IN ACCORDANCE WITH PUB. 408 SECTION 805 AT THE RATE OF 1240 LBS./1000 S.Y.

A COMPOST BLANKET WHICH MEETS THE STANDARDS OF THE PA DEP "EROSION AND SEDIMENT CONTROL BEST MANAGEMENT PRACTICE MANUAL" MAY BE SUBSTITUTED FOR THE SOIL AMENDMENTS SHOWN.

DO NOT USE WOOD MULCH WHEN SEEDING NATIVE SPECIES USING HYDROSEEDING PROCEDURES. WHEN SEEDING NATIVE SPECIES, TACKIFIER MUST NOT BE GREATER THAN 1/2 INCH THICK.

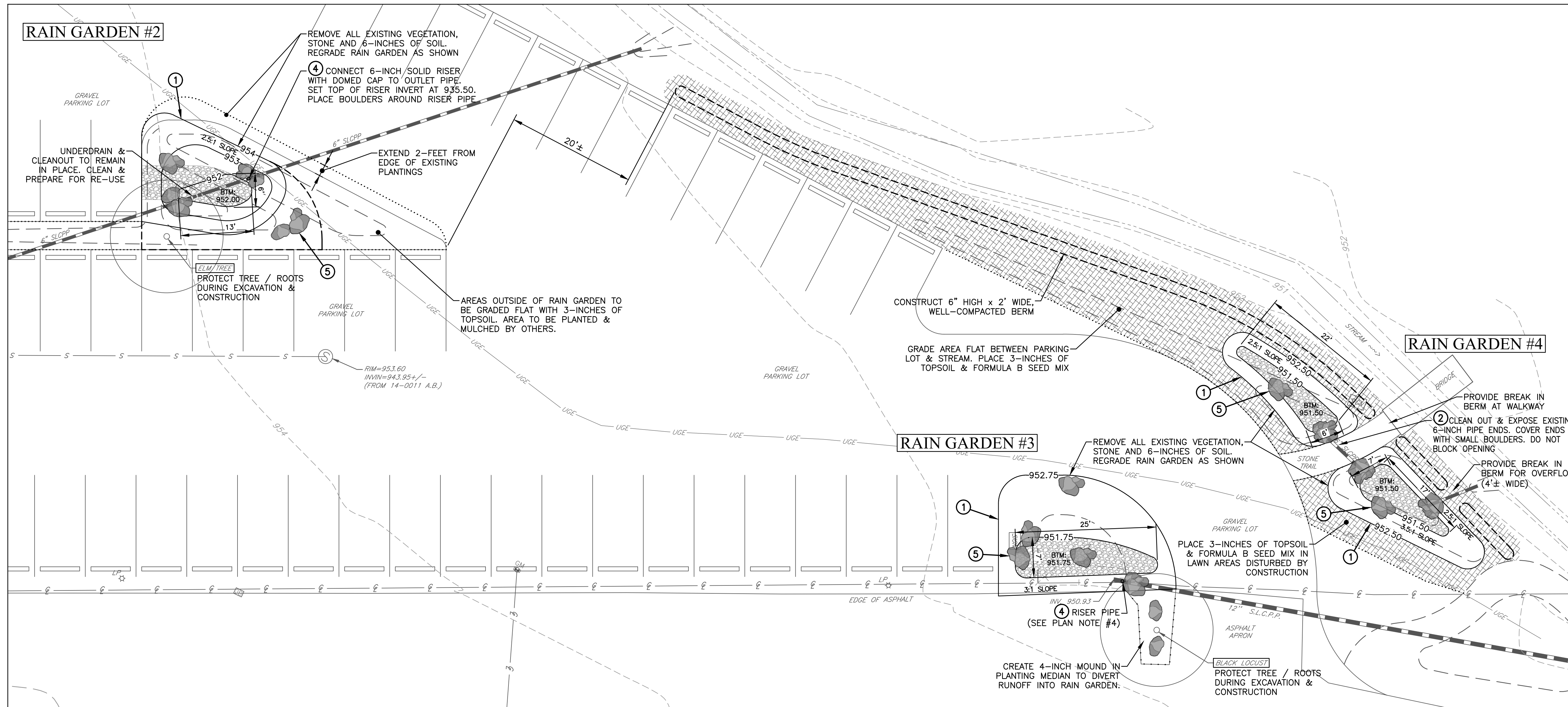
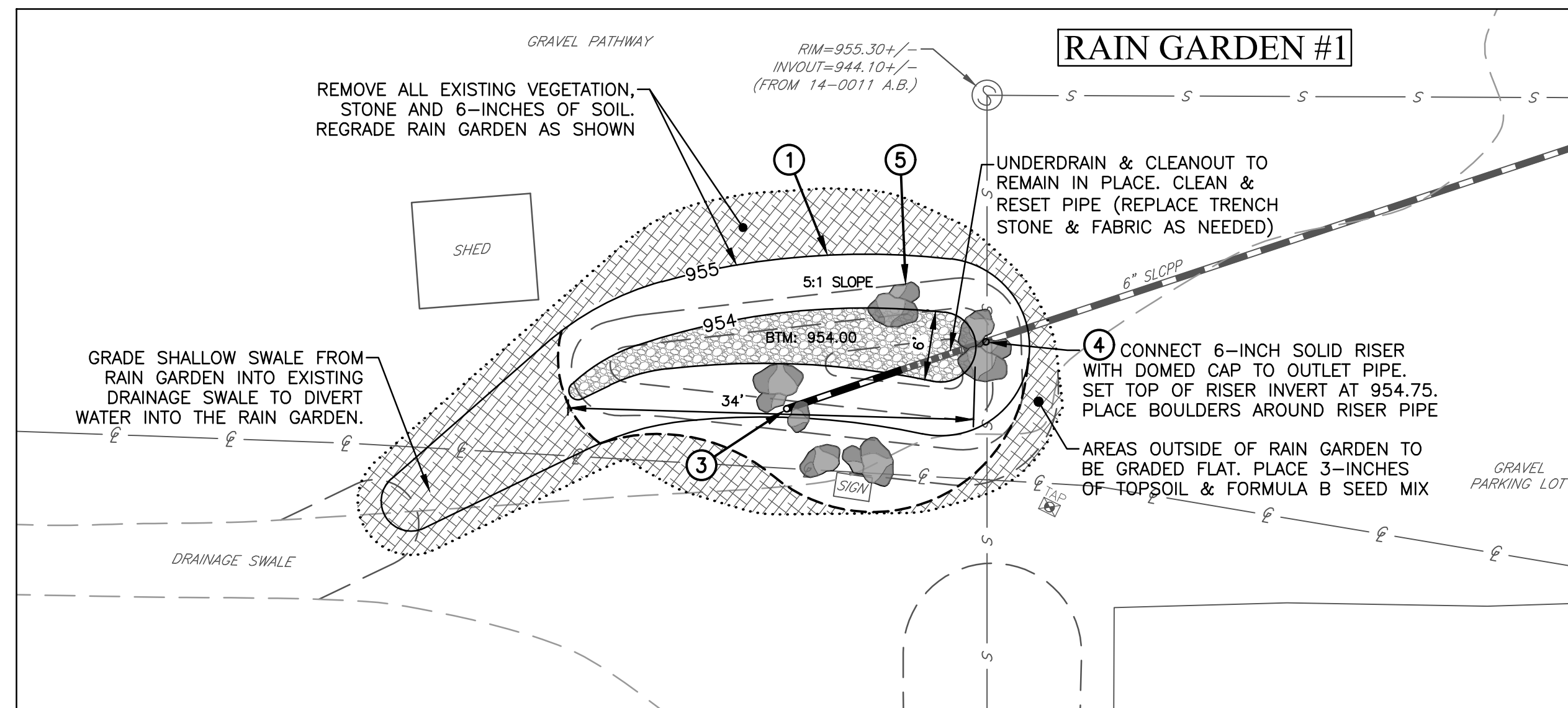

Copyright © 2024 by Stiffler, McGraw & Associates, Inc. Except as permitted under U.S. Copyright laws, no part of this plan may be reproduced, stored in a retrieval system, or transmitted in any form or by any means without the prior written permission of Stiffler, McGraw & Associates, Inc.

PLAN NOTES

1. ALL HARDWOOD MULCH AND PLANTINGS SHOWN WILL BE INSTALLED BY OTHERS.
2. ALL AREAS OF TOPSOIL AND SEED SHALL BE INSTALLED BY THE CONTRACTOR (SEE DRAWING 'S2' FOR ADDITIONAL INFORMATION).



1731 N. Juniata Street
Hollidaysburg, PA 16648
Phone: 814.696.6280 Fax: 814.696.6240

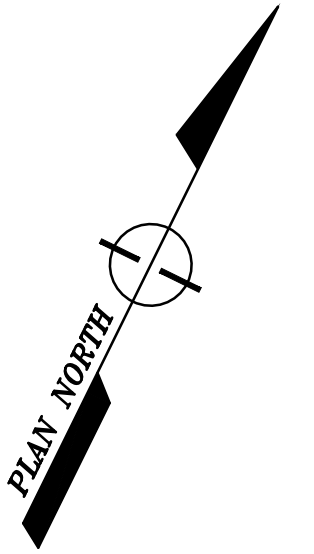

Stiffler, McGraw & Associates, Inc.

Owner:
**BLAIR REGIONAL YMCA &
THE BLAIR COUNTY
CONSERVATION DISTRICT**
HOLLIDAYSBURG, PENNSYLVANIA 16648

Project Name:
**YMCA RAIN GARDEN
RECONSTRUCTION PROJECT**

2024-1

HOLLIDAYSBURG BOROUGH
BLAIR COUNTY, PENNSYLVANIA

AS-BID

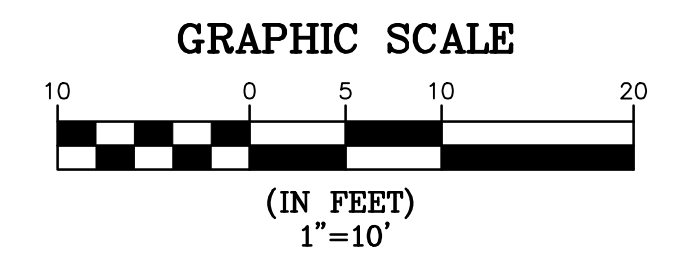

Revisions:

No.	Date	Description

Sheet Title:

PLANTING PLANS

PROJECT NO.	22-2024
DRAWN BY:	CSF
DESIGNED BY:	CSF
CHECKED BY:	GTG
SCALE:	AS SHOWN

Drawing:

S3

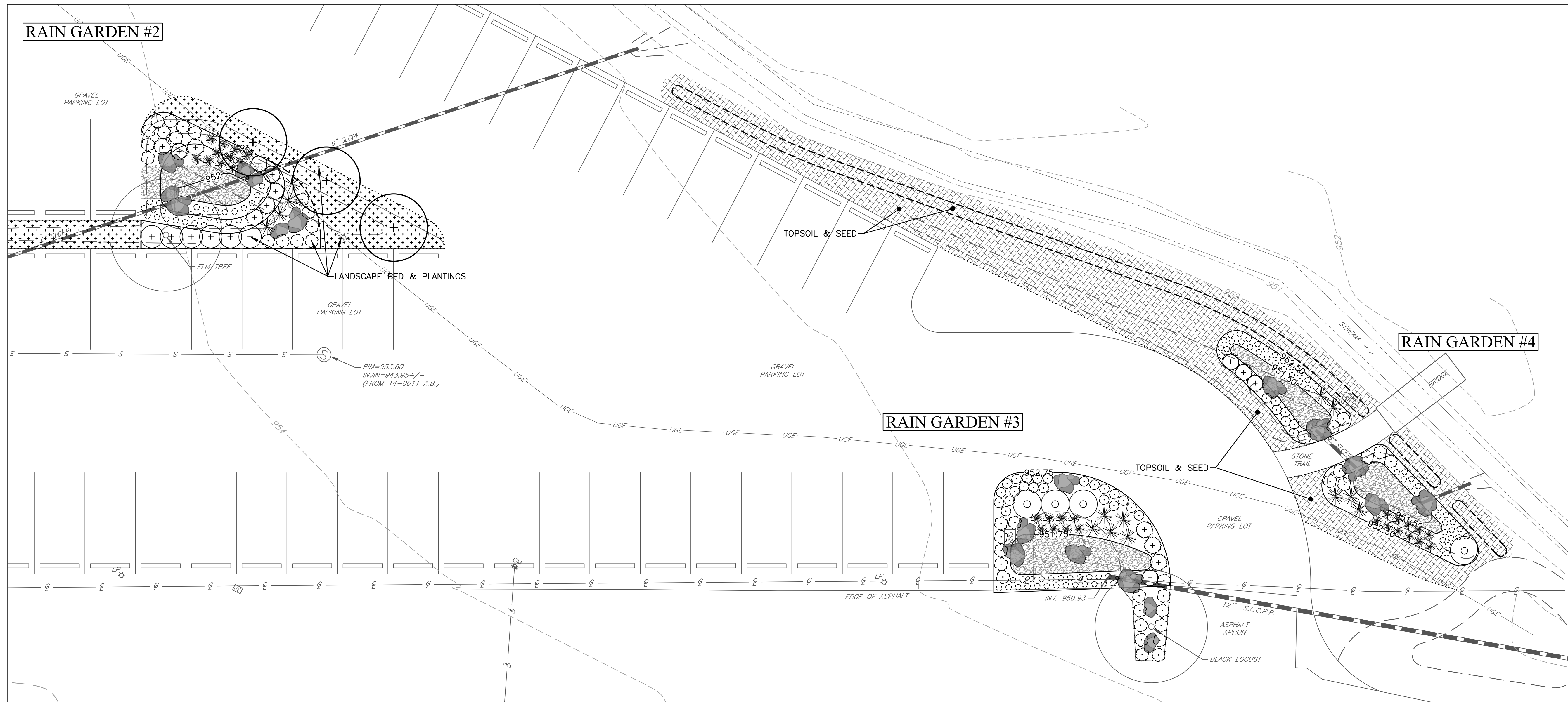
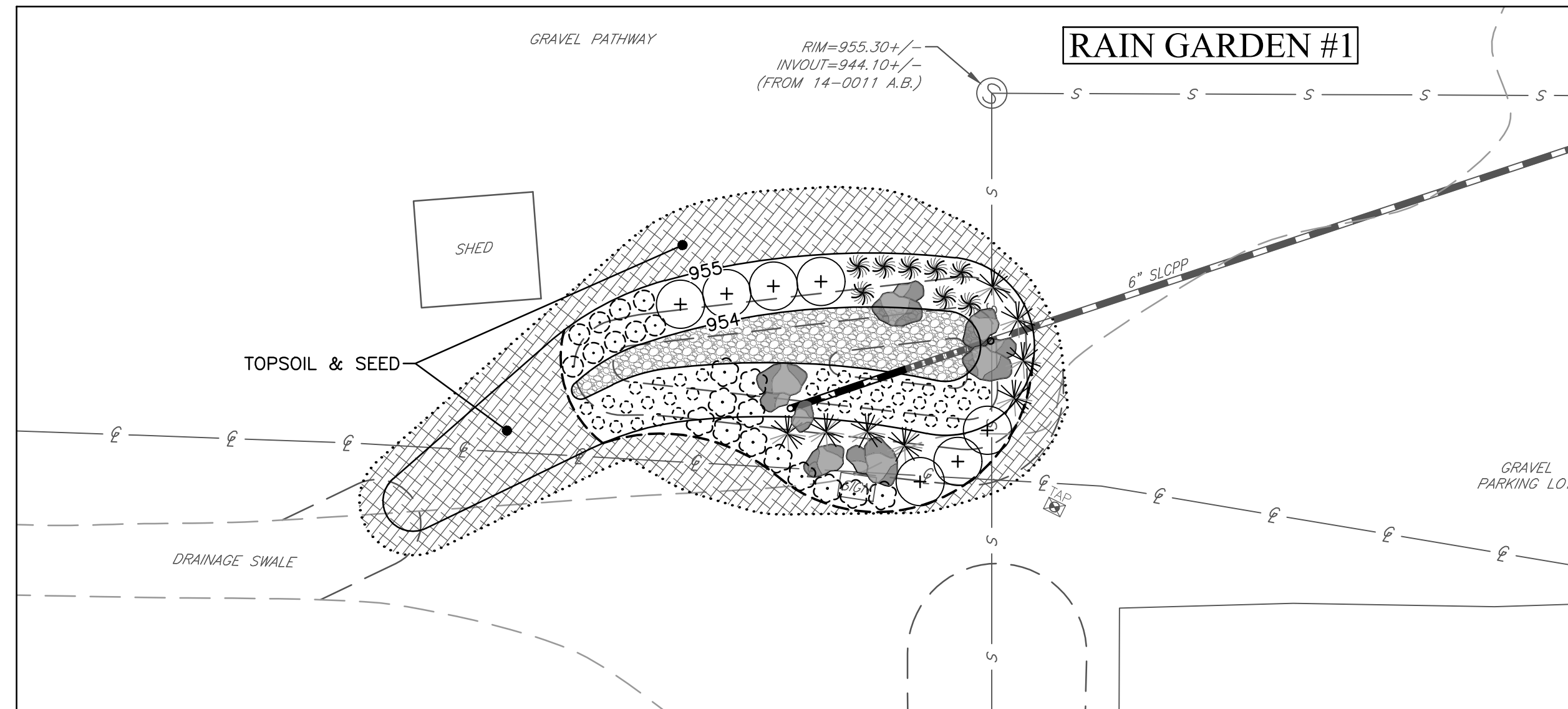

Copyright © 2024 by Stiffler, McGraw & Associates, Inc. Except as permitted under U.S. Copyright laws, no part of this plan may be reproduced, stored in a retrieval system, or transmitted in any form or by any means, without the prior written permission of Stiffler, McGraw & Associates, Inc.

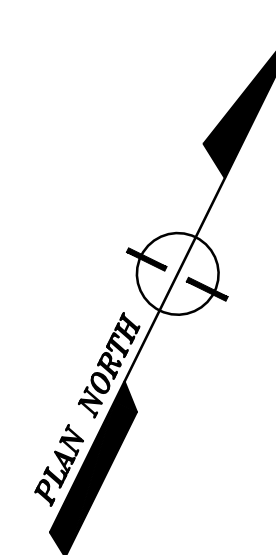

Stiffler, McGraw & Associates, Inc.

Owner:
**BLAIR REGIONAL YMCA &
THE BLAIR COUNTY
CONSERVATION DISTRICT**
HOLLIDAYSBURG, PENNSYLVANIA 16648

Project Name:
**YMCA RAIN GARDEN
RECONSTRUCTION PROJECT**

2024-1
HOLLIDAYSBURG BOROUGH
BLAIR COUNTY, PENNSYLVANIA

AS-BID

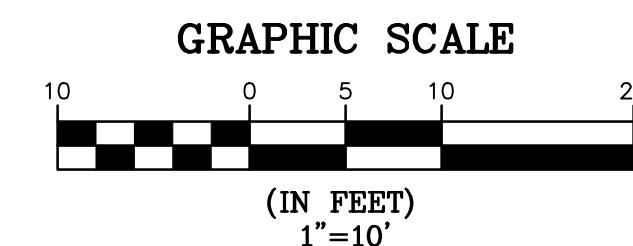

Revisions:

No.	Date	Description

Sheet Title:

DETAILS

PROJECT NO. 22-2024

DRAWN BY: CSF

DESIGNED BY: CSF

CHECKED BY: GTG

SCALE: AS SHOWN

Drawing:

D1

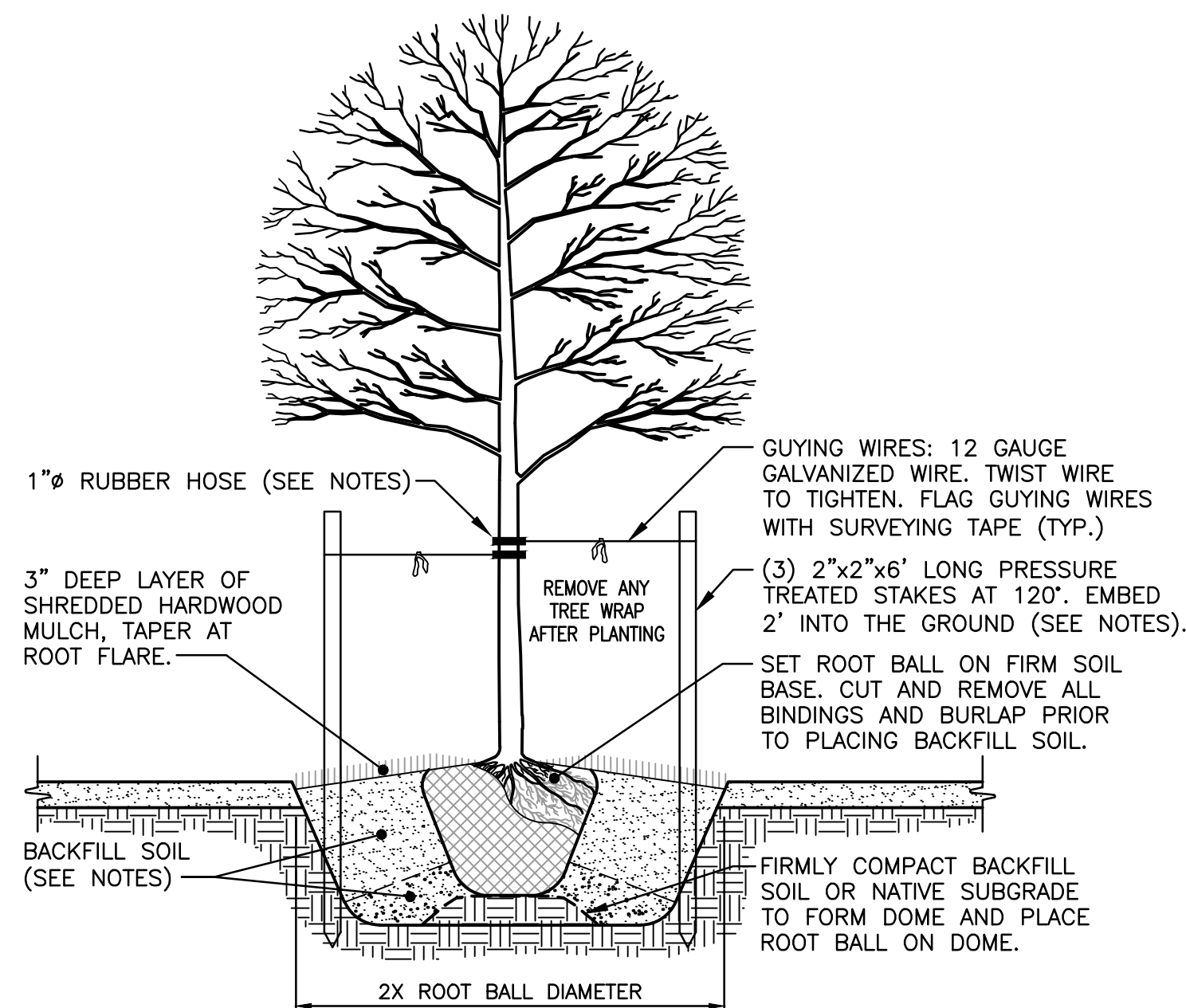

- NOTES:**
- PLANT SO THAT TOP OF ROOT BALL IS EVEN OR 1" HIGHER THAN FINISHED GRADE.
 - BACKFILL WITH NATIVE SOIL FROM EXCAVATION. SOIL SHOULD BE LOOSE AND FREE OF CLUMPS. PLACE SOIL IN BOTTOM OF TREE PIT AND COMPACT TO PREVENT ROOT BALL FROM SHIFTING. DO NOT COMPACT REMAINDER OF TREE PIT SOIL. FIRM SOIL AROUND ROOT BALL AND WATER THOROUGHLY. DO NOT COVER TOP OF ROOT BALL WITH SOIL.
 - REMOVE ONLY BROKEN OR DEAD BRANCHES. DO NOT PRUNE ANY HEALTHY BRANCHES AT TIME OF PLANTING.
 - TREE STAKES SHOULD ONLY BE USED IF TREE IS PLANTED IN EXTREMELY WINDY CONDITIONS OR IF BACKFILL SOIL IS VERY SANDY, OR VERY WET CLAY. IF USED, COORDINATE REMOVAL OF STAKES, WIRING AND HOSE FOR 1-YEAR AFTER PLANTING.

TREE PLANTING DETAIL (BY OTHERS)

N.T.S.

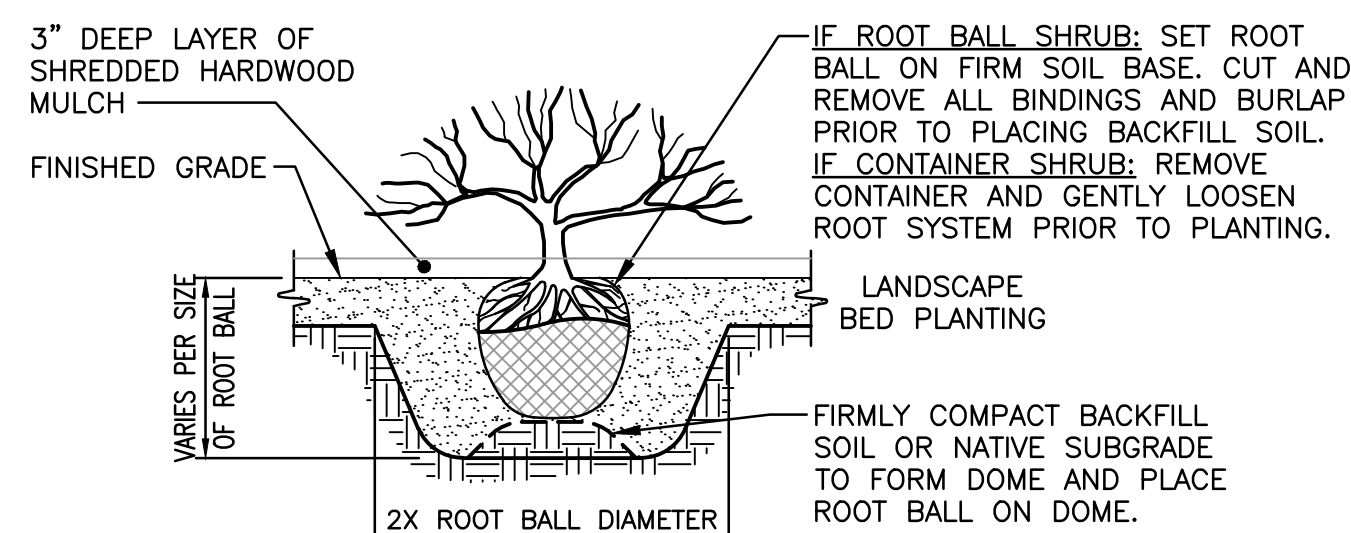

- NOTES:**
- PLANT SO THAT TOP OF ROOT BALL IS EVEN OR 1" HIGHER THAN FINISHED GRADE.
 - REMOVE ONLY BROKEN OR DEAD BRANCHES. DO NOT PRUNE ANY HEALTHY BRANCHES AT TIME OF PLANTING.

SHRUB PLANTING DETAIL (BY OTHERS)

N.T.S.

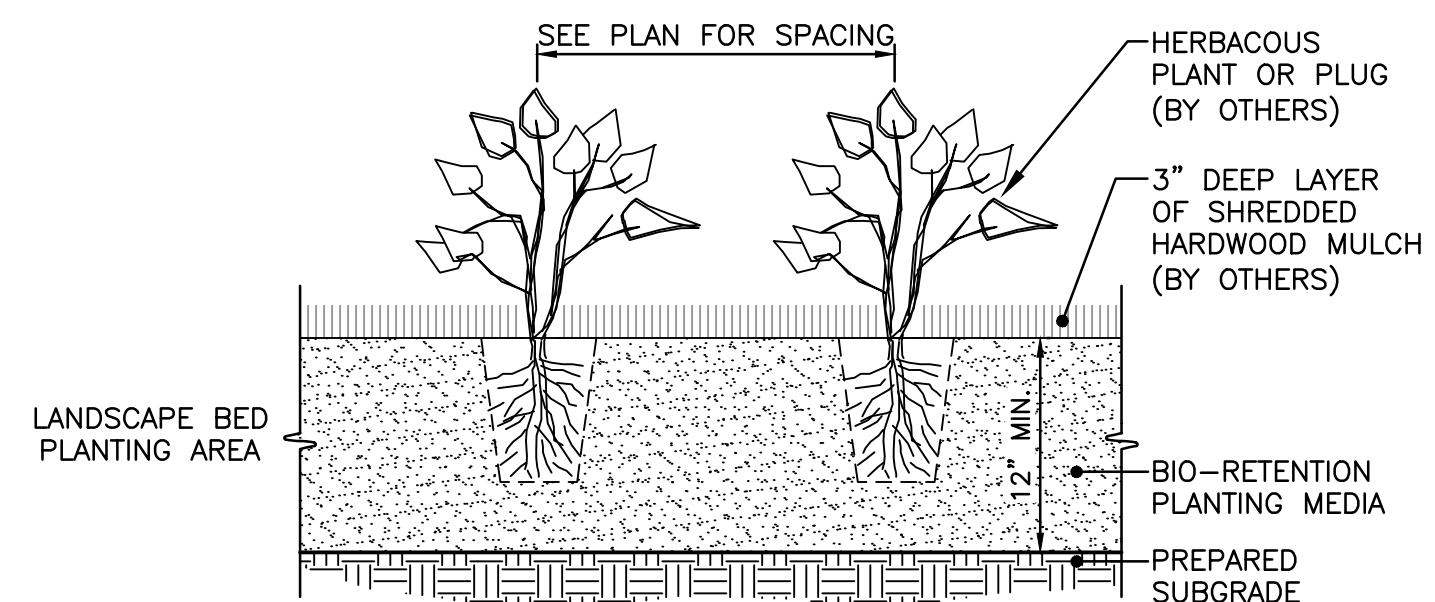

- NOTES:**
- SHREDDED HARDWOOD MULCH: MULCH SHALL BE DOUBLE-GROUND SHREDDED HARDWOOD, NATURAL IN COLOR.
 - FIRM SOIL AROUND PLANTINGS AND WATER THOROUGHLY. DO NOT COMPACT SOIL.
 - REMOVE CONTAINER AND GENTLY LOOSEN ROOT SYSTEM.
 - PLANT SO THAT TOP OF ROOT SYSTEM IS EVEN OR 1" HIGHER THAN FINISHED GRADE.

LANDSCAPE BED PLANTING DETAIL

N.T.S.

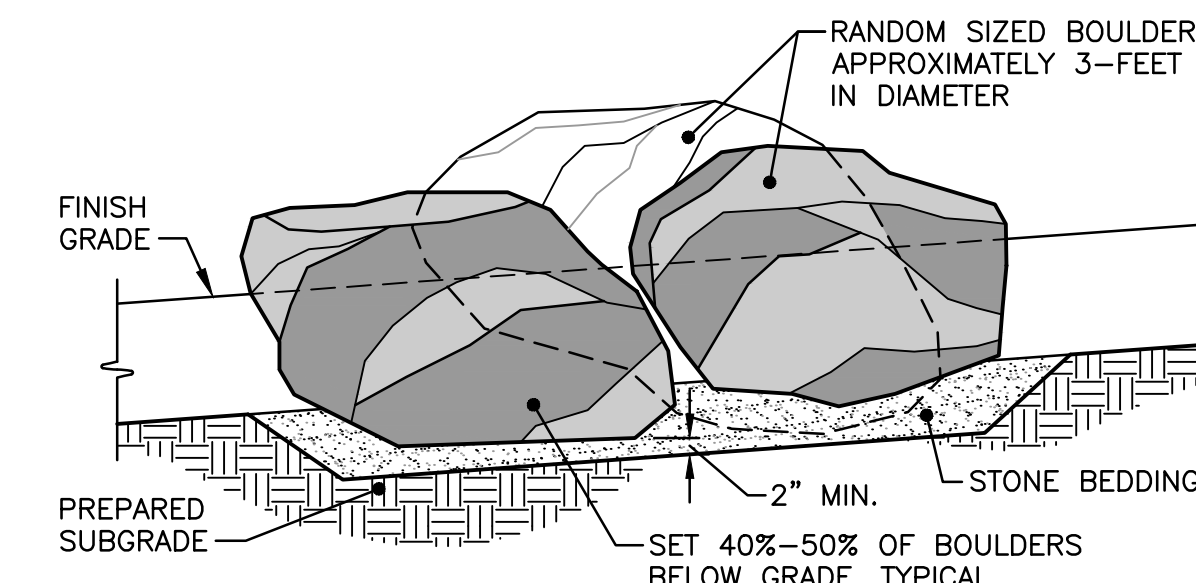

- NOTES:**
- THE DESIGN INTENT IS TO RESEMBLE STONE/ BOULDER OUTCROP FORMATIONS AS SEEN IN THE NATURAL ENVIRONMENT.
 - REFERENCE LANDSCAPING PLAN FOR VARIOUS LOCATIONS OF BOULDER OUTCROP AREAS. PROVIDE QUANTITIES AS SHOWN ON THE PLAN.

BOULDER OUTCROP DETAIL

N.T.S.

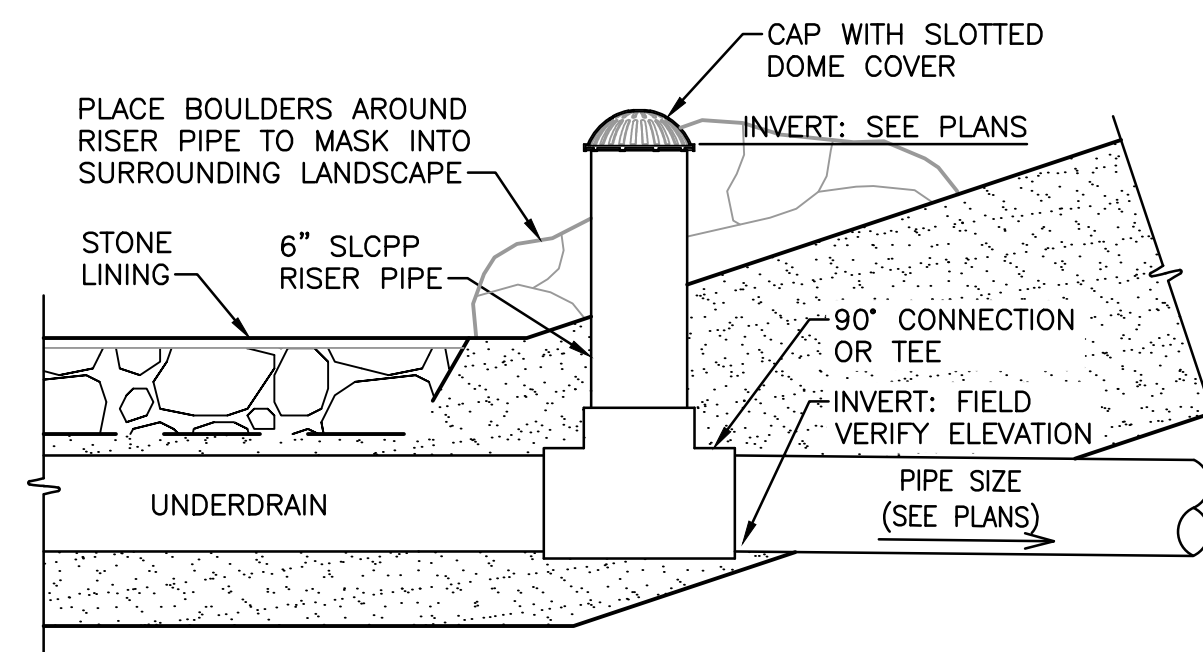

- NOTE:**
CLEAN & REUSE EXISTING PIPES. PROVIDE RISER PIPE, CAP AND CONNECTION.

RISER PIPE

N.T.S.

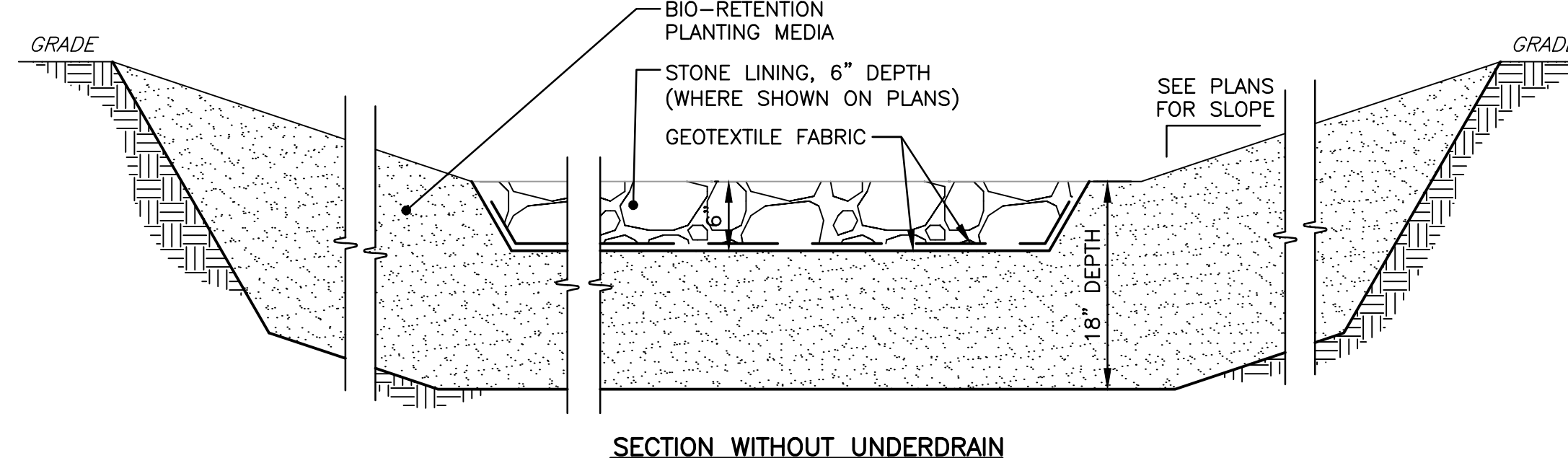

SECTION WITHOUT UNDERDRAIN

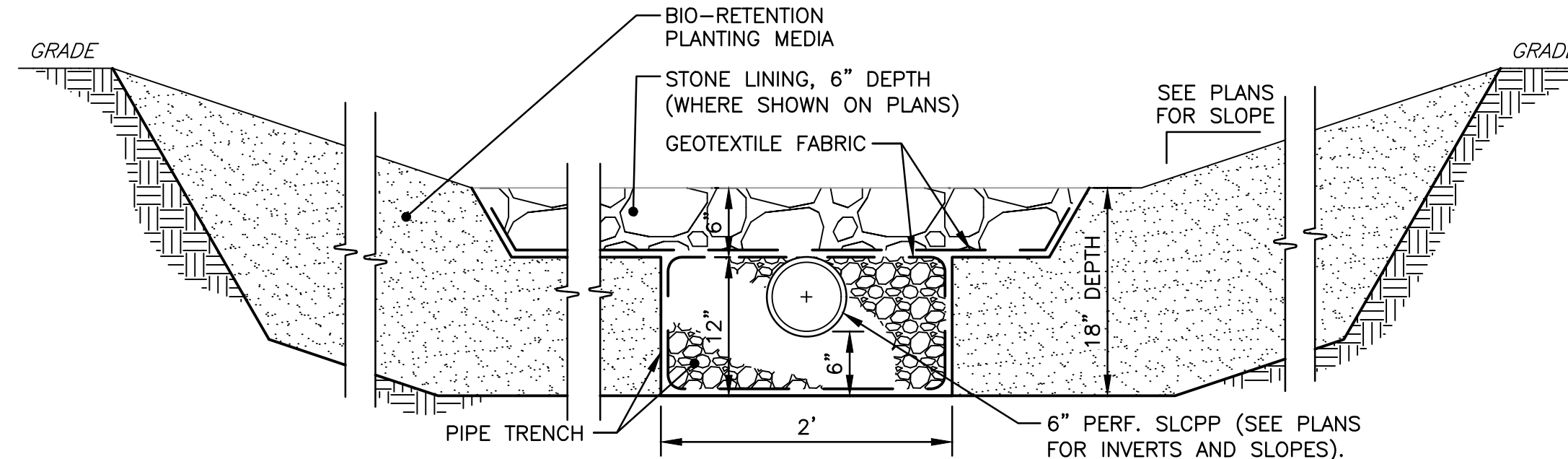

SECTION WITH UNDERDRAIN

- NOTES:**
- BIO-RETENTION PLANTING MEDIA TO BE 45%-50% TOPSOIL, 10%-20% WELL-COMPOSTED ORGANIC COMPOST, AND 30%-35% SAND, WELL BLENDED AND PREPARED FOR PLANTING. GRADE TO A SMOOTH, UNIFORM SURFACE WITH FIRM (NOT COMPACTED), FINE TEXTURE.
 - STONE LINING TO BE FLAT, WASHED, AND ROUNDED NATURAL STONE, 6"-12" RANGE.
 - GEOTEXTILE FABRIC TO BE TERRA-TEX EP-12 BY HANES GEO OR APPROVED EQUAL.
 - FILL PIPE TRENCH WITH CLEAN NO. 2B STONE. OVERLAP GEOTEXTILE FABRIC AT TOP OF TRENCH BY 1 FT. PRIOR TO PLACEMENT OF BIO-RETENTION PLANTING MEDIA.

RAIN GARDEN

N.T.S.

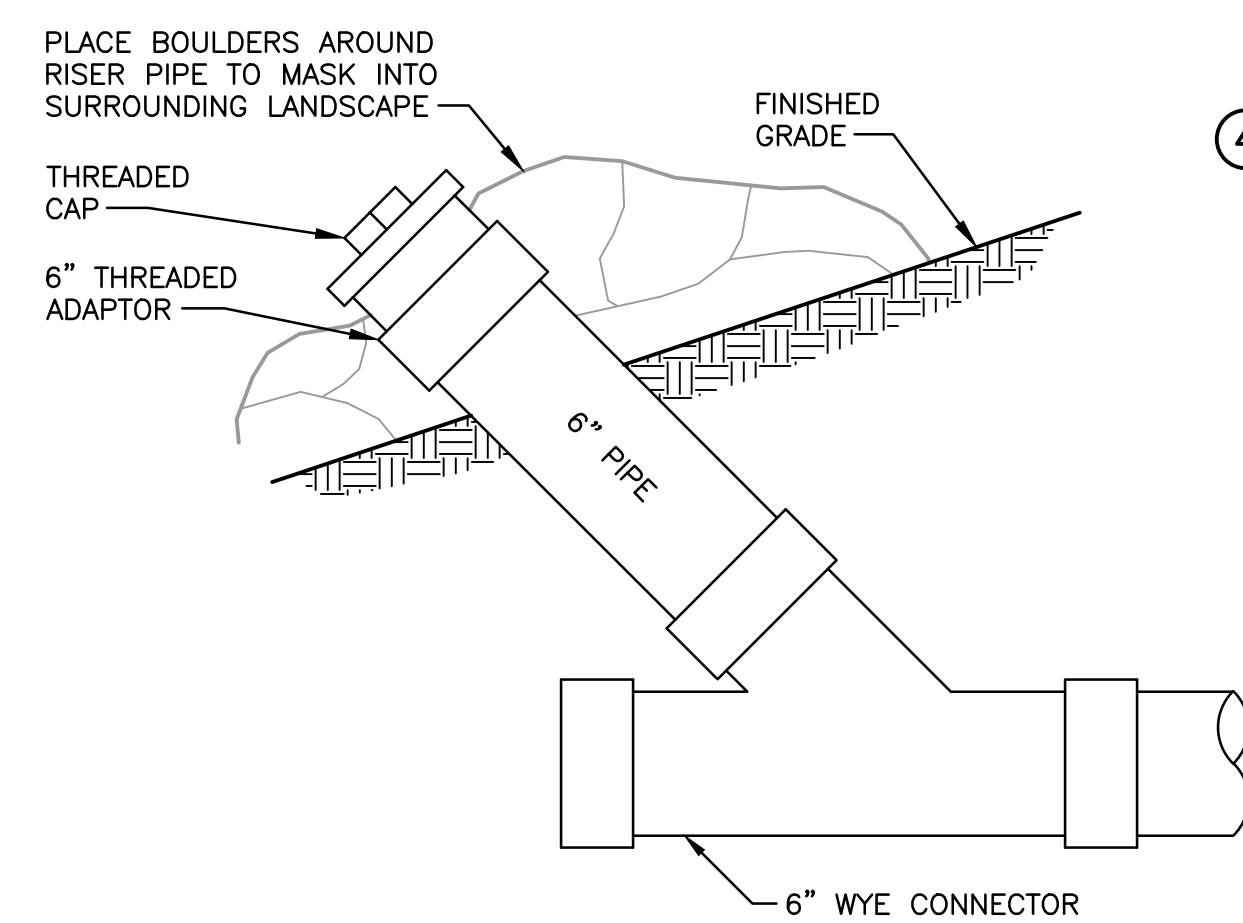

- NOTE:**
CLEAN & REUSE EXISTING PIPES & FITTINGS.

STANDARD CLEANOUT

N.T.S.

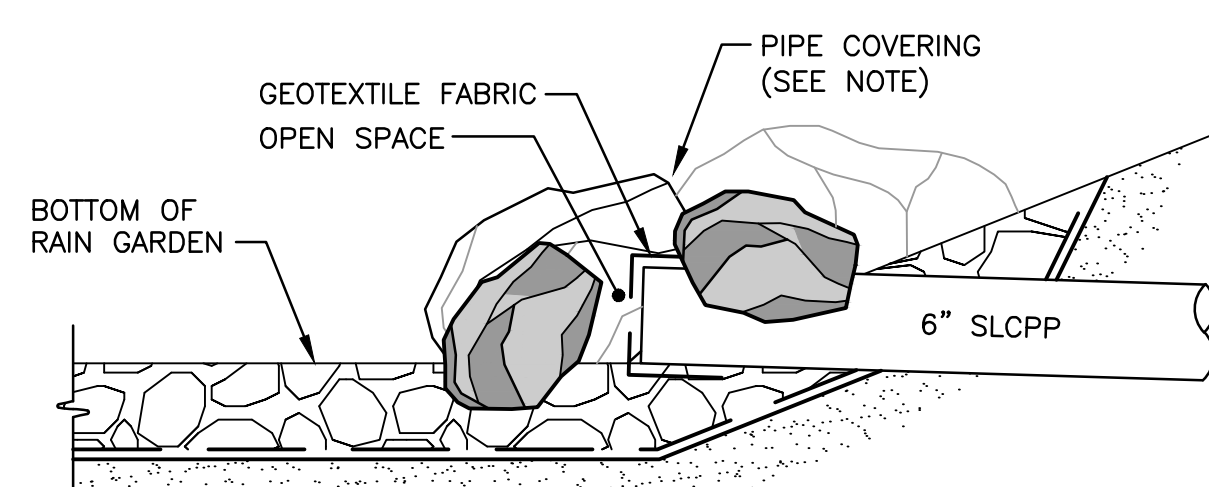

- NOTE:**
CLEAN & REUSE EXISTING PIPE. COVER PIPE OPENING WITH NON-WOVEN GEOTEXTILE FABRIC. STRAP FABRIC TO PIPE. PLACE SMALL TO MEDIUM BOULDERS IN FRONT OF AND AROUND PIPE TO FULLY COVER EXPOSED PIPE. MAINTAIN OPEN SPACE AT PIPE INLET.

PIPE OUTLET

N.T.S.